

A

B

C

D

E

A

B

C

D

E

**NOTES**

1. ALL DIMENSIONS IN MILLIMETERS (mm) UNLESS OTHERWISE NOTED.
2. ALL CHANGES IN DIRECTION OF COMMS / DTS CONDUIT ACHIEVED USING LONG RADIUS SWEEPING BENDS.
3. WHEN LAYING CONDUITS, ENSURE CLEARANCE FROM TREFOIL BRACKETS.
4. START OF CIRCUIT BREAKOUT MUST COMMENCE 1000mm BEFORE TREFOIL SPACER.
5. WARNING TAPE TO DISPLAY "DANGER - ELECTRIC CABLES BELOW"
6. LONG RADIUS SWEEPING BENDS CAN EITHER BE MADE UP FROM BENDING CONDUIT LENGTHS OR AS SPECIFIED ON ROUTE DESIGN IN COMPLIANCE WITH NS234.
7. CONDUIT 1 POSITION TO BE UTILISED IN A DUAL CIRCUIT TREFOIL CONFIGURATION.
8. CONDUIT 2 POSITION TO BE UTILISED IN A SINGLE CIRCUIT TREFOIL CONFIGURATION.
9. COMMUNICATIONS CABLE MARKERS TO BE INSTALLED WHEN COMMUNICATIONS / DTS CONDUIT DEVIATES FROM HV CONDUITS. MARKERS INSTALLED AT MAX 5m SPACINGS AND EVERY CHANGE IN DIRECTION

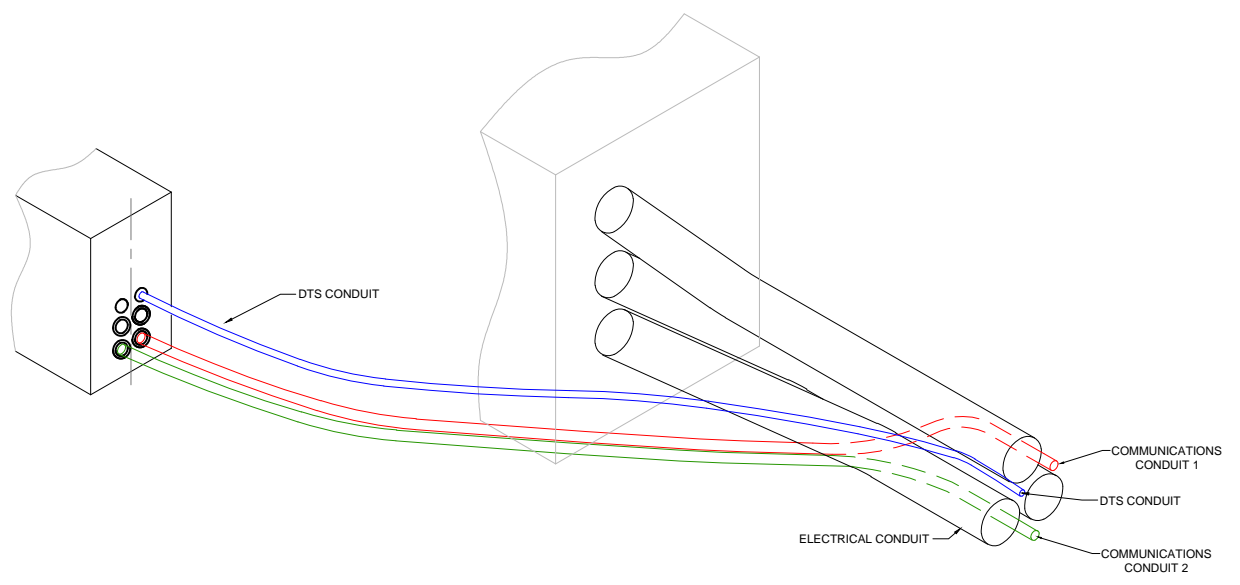
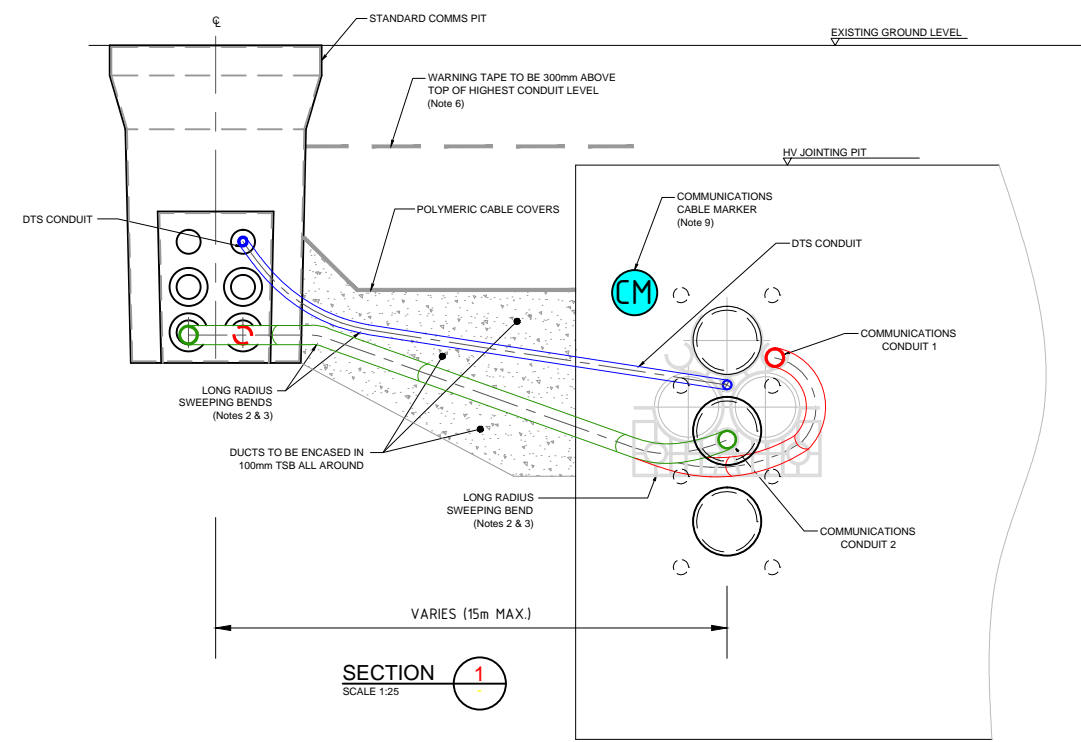
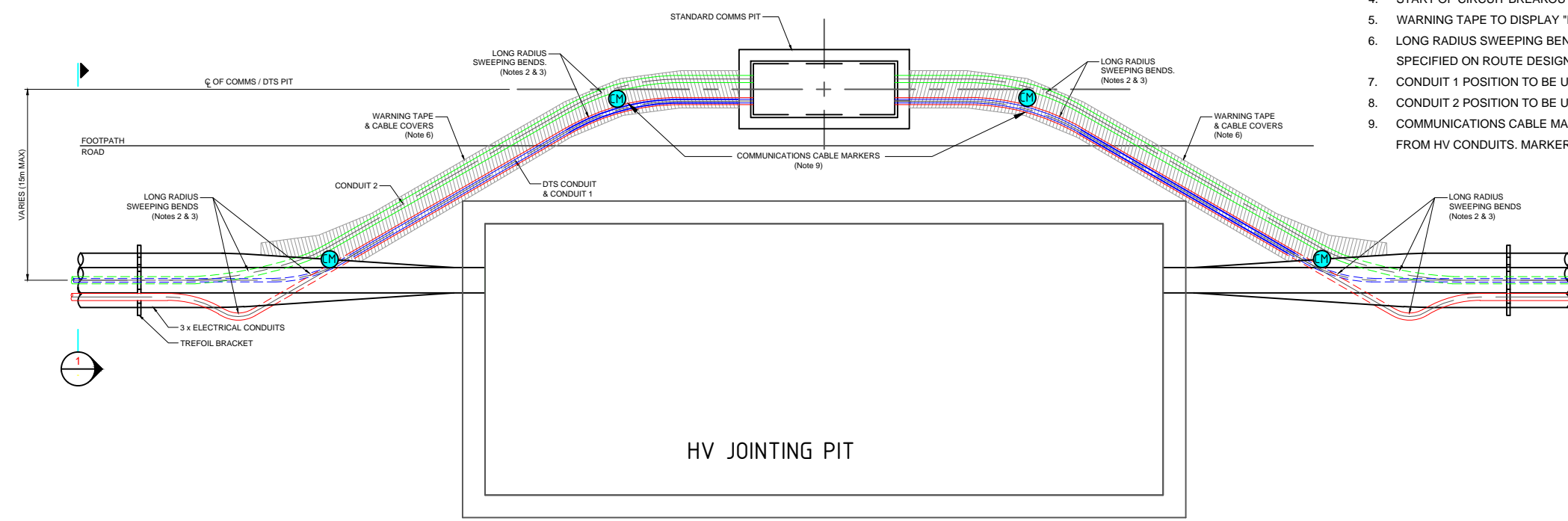

20111014

CAD DRAWING DO NOT MANUALLY AMEND	<b>AMENDMENTS</b>	
	14/11/13	27/02/15
	1 Amendment to title block.	2 Amendment to notes

NETWORK STANDARD

COMMUNICATIONS ENGINEERING  
145 NEWCASTLE RD  
WALLSEND 2287

SCALE	AS SHOWN
DESIGNED	A.FREESTONE
DRAWN	A.FREESTONE
CHECKED	D.TITMARSH
APPROVED	A.LLOYD
DATE	01/02/2013
PROJECT NUMBER	STD
PROJTRAK NUMBER	

**AUSGRID FIBRE NETWORK  
FIBRE & DUCT ARRANGEMENT  
COMBINED DTS & COMMS  
TYPICAL BREAKOUT TO BYPASS  
HV JOINTING PIT (SINGLE CIRCUIT)**

SIZE	DRAWING No	SHEET	AMD
A3	212393	12	2