

DRILLING DETAILS

CONSTRUCTION

STANDARD CONSTRUCTION
2700mm CROSSARMS FOR
LV 11kV 22kV AND 33kV
CONSTRUCTION DETAILS

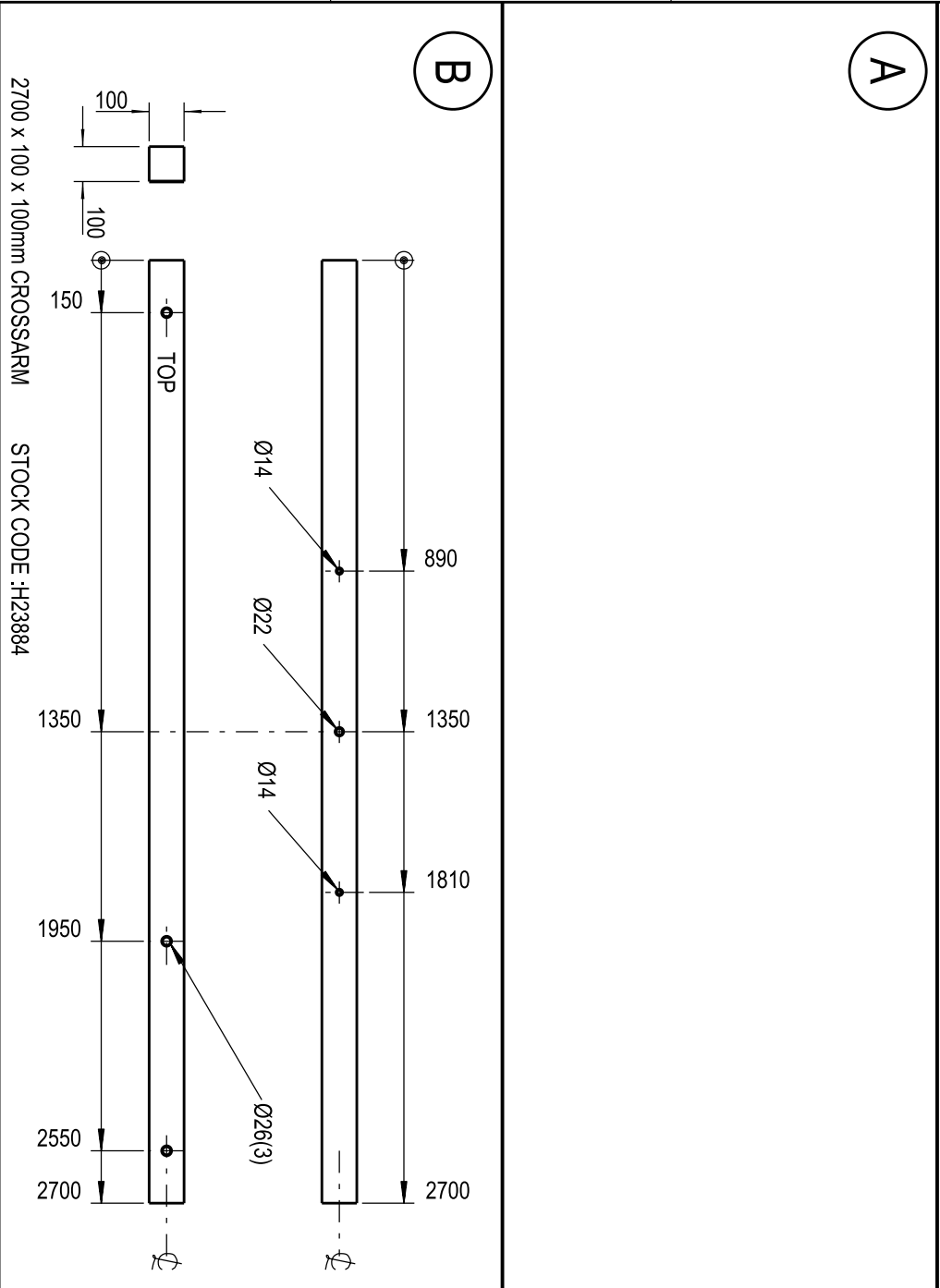

- 2-1 4-6
- 2-5 4-7
- 2-6 4-8E
- 2-7 4-8C/E
- 2-38 4-9E
- 2-438 4-9C/E
- 3-1 4-35C/E
- 3-5 4-14
- 4-1 4-35E
- 4-1E
- 4-1C/E
- 4-5

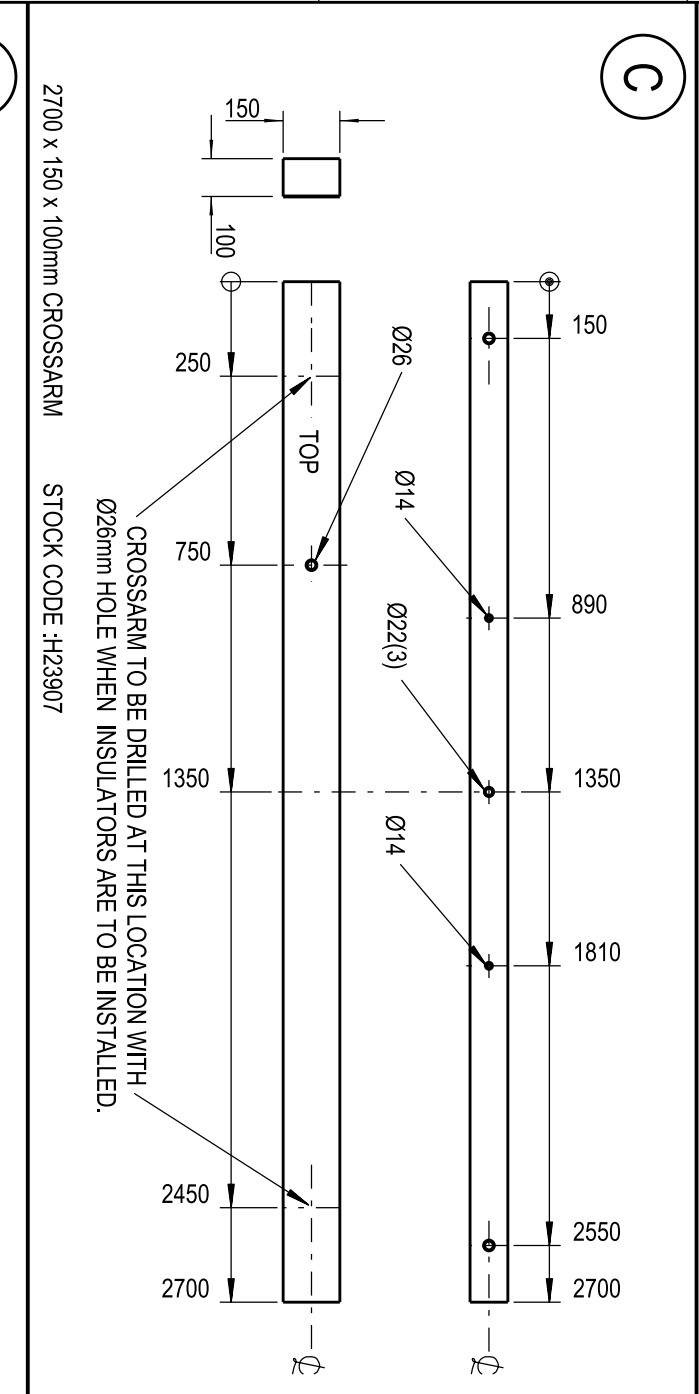

- 2-10 3-10
- 2-11 3-11
- 2-12
- 2-14
- 2-30
- 2-31
- 2-37
- 2-38
- 2-60
- 2-60CCT
- 2-411
- 2-412
- 2-430
- 2-431
- 2-437

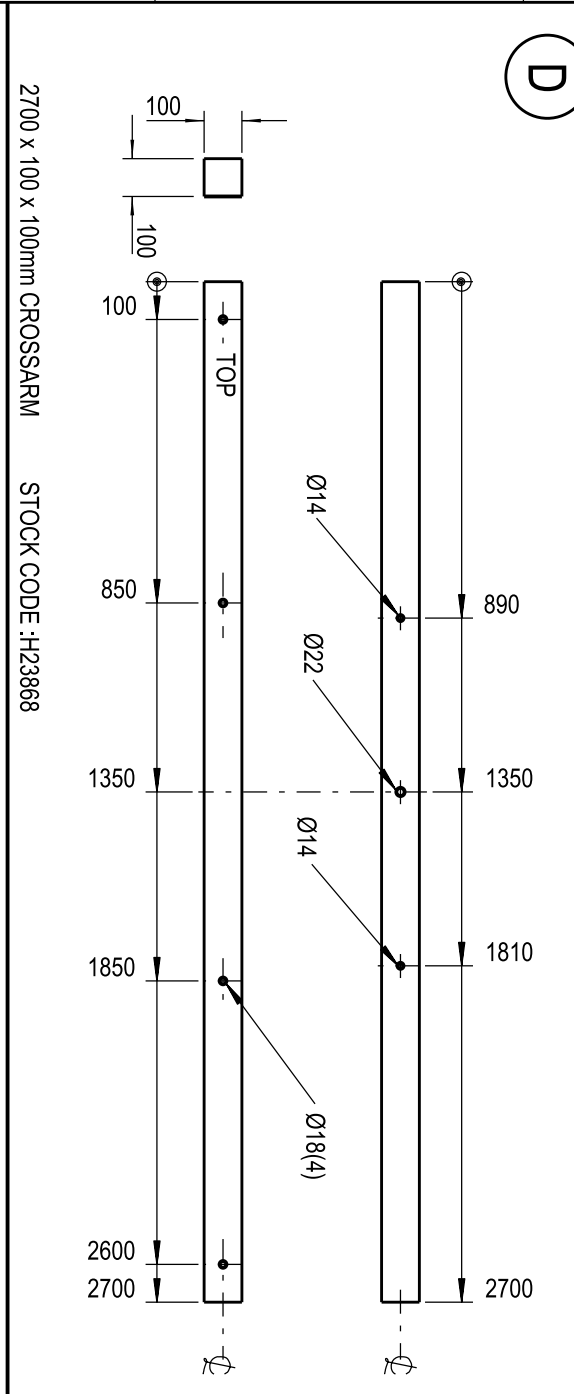

- 1-1
- 1-3
- 1-13
- 1-14
- 1-100
- 1-101
- 1-102
- 1-103

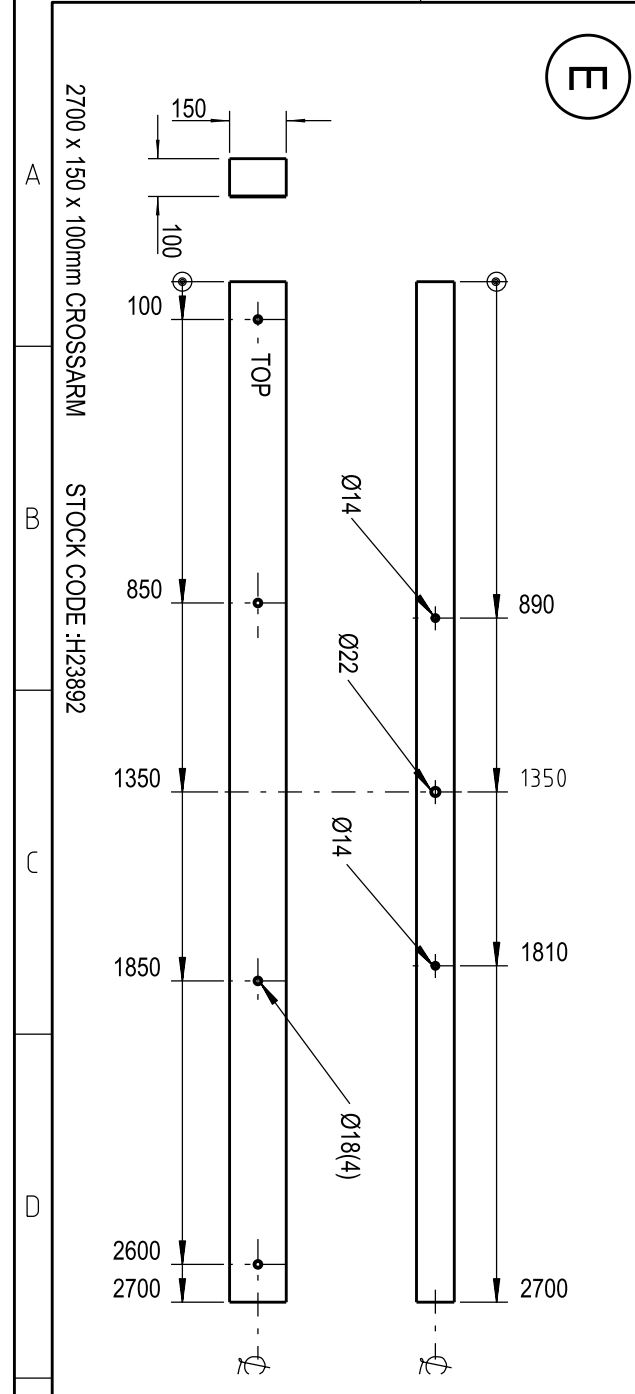

- 1-10
- 1-11
- 1-12
- 1-14
- 1-16
- 1-72
- 1-104
- 1-105
- 1-107

<p>APP'D by: GLENN FORD</p>	<p>NETWORK STANDARD</p> <p>145 NEWCASTLE RD WALLSEND, NSW 2287</p>	<p>SCALE: 1:20</p> <p>DESIGNED: -</p> <p>DRAWN: P.S</p> <p>CHECKED: -</p> <p>APPROVED: R.BREMPELL</p> <p>DATE: 07/11/95</p> <p>PROJECT NUMBER: STD</p> <p>PROJTRAK NUMBER: -</p>	<p>STANDARD CONSTRUCTION 2700mm CROSSARMS FOR LV 11kV 22kV AND 33kV CONSTRUCTION DETAILS</p>	<p>SIZE: A3</p>	<p>DRAWING No: 514373</p>	<p>SHEET: 01</p>	<p>AMD: 17</p>
<p>CONSTRUCTION ADDED 2022/10/06 DATE: E:VAD</p> <p>PHILLIP JONES</p> <p>PATRICIA RIOS</p> <p>APPLIED.</p> <p>91</p> <p>4/102/50/20 DATE: E:VAD</p> <p>GLENN FORD</p> <p>DARRY CRAIG</p> <p>DARRY CRAIG</p> <p>NMENT S</p> <p>DO NOT MANUALLY AMEND CAD DRAWING</p>							